



SPECIALTY TOP CO.

INSTALLATION INSTRUCTIONS BRONCO 1980-1991 PART #334-055

Thank you for purchasing Specialty's Cab/Tonneau for your Bronco. It has been designed for great fit and long wear. Please read and follow, precisely, all installation instructions provided when installing top. Failure to do so may result in a poor fitting top and could place occupants in a potentially hazardous situation.

TOOLS REQUIRED:

3/8" WRENCH DRILL BITS (1/8" & 3/16")
ELECTRIC DRILL #2 PHILLIPS SCREWDRIVER
8' TAPE MEASURE FLAT TIP SCREWDRIVER

Butt both pieces of tailgate aluminum (Items 4 & 5) together on top edge of tailgate. Center from left to right and 1/2" from the rear of the body aluminum to the rear edge of tailgate aluminum. Making sure that tailgate aluminum is parallel with tailgate, mark and drill 1/8" holes using tailgate aluminum as a template. Secure to tailgate with #10 x 1/2" sheet metal screws (Item 2). See figure 1.

INSTALLATION TIPS

Before you begin installing this top, here are a few tips to make installation easier.

This top should be installed where the temperature is above 72 degrees Fahrenheit. Below this temperature, the top may contract making it difficult to install.

It is normal for a top to contract and wrinkle when stored in the shipping carton. The top will relax and wrinkles will disappear within a few days of installation as fabric adjusts to shape of mounting hardware.

INSTALLATION PROCEDURES:

Refer to page 4 to assure that all parts are included in your kit.

Step 1. Body Aluminum. Locate rear body aluminum (Item 1) just outside slight drop in body edge and 2" to the rear of notch in body. The body aluminum should be on the same surface level as the tailgate. Using body aluminum as a template, mark and drill 1/8" holes. Secure to body with #10 x 1/2" sheet metal screws (Item 2). Butt front body aluminum (Item 3) up to rear body aluminum. Mark and drill 1/8" holes using front body aluminum as a template. Secure to body with #10 x 1/2" sheet metal screws (Item 2). The last sheet metal screw will be installed on the vertical edge at bottom rear of cab. See figures 1 and 2.

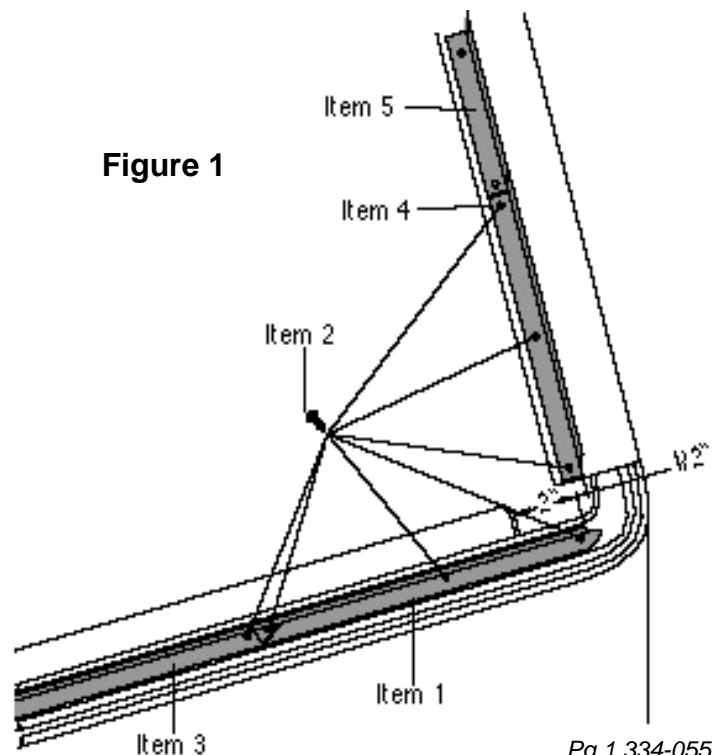

Figure 1

Step 2. Cab Aluminum. Position bottom of cab aluminum (Item 6) even with seam in body at rear of cab. Starting at the bottom mark and drill 1/8" holes using cab aluminum as a template. Secure to cab with #10 x 1/2" sheet metal screw (Item 2). Drill and install one screw at a time making sure that cab aluminum follows the contour of cab. Slight bending of cab aluminum may be necessary. Butt cab aluminum pieces together at center of cab. Mark, drill and install screws using same procedure. Make sure that cab aluminum will follow contour of cab before drilling. See figure 2.

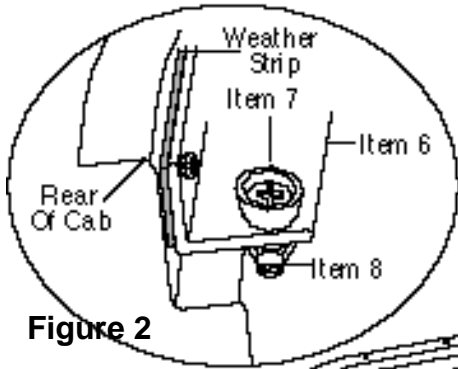
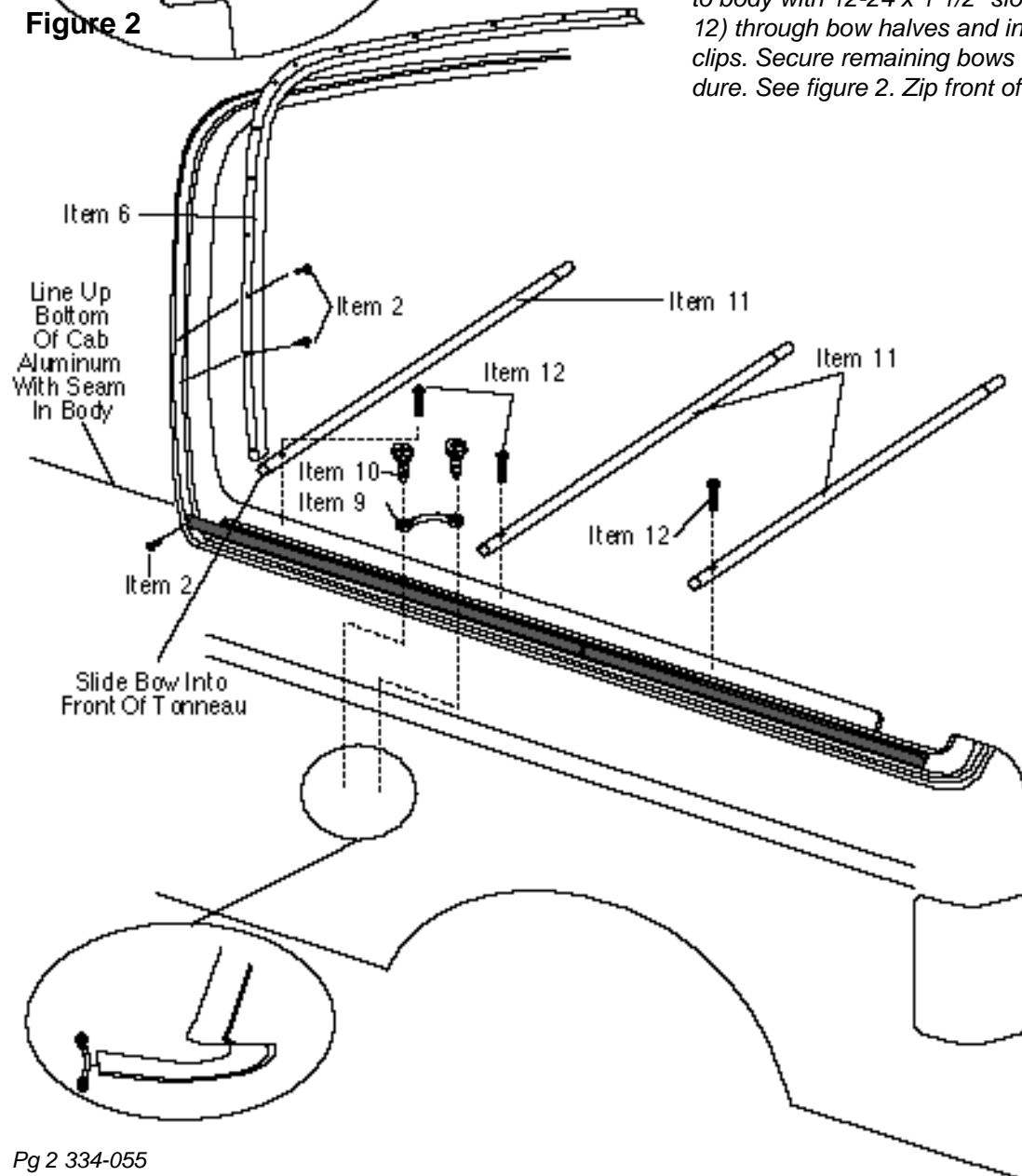

Figure 2

Step 3. Cab Curtain Installation. Measure 3" to the right of center split in cab aluminum and 1/4" from the rear edge of cab aluminum. Mark and drill 3/16" hole. Place machine screw stud (Item 7) into hole and secure with #10-32 hex nut (Item 8). Find top center of cab curtain and secure snap to the right of center, to stud just installed. Install remaining screw studs on cab aluminum alternating from left to right. Pull on the top until smooth. Mark for best hole location using cab curtain as a guide. Install each stud and snap into position until all studs are in place on cab aluminum. Pull hook and loop straps at bottom of cab curtain towards the floor of vehicle. Place footman loop (Item 9) at this position. Mark and drill 1/8" holes using footman loop as a template. Secure to floor with #8 x 1/2" sheet metal screws (Item 10). Repeat for the other side. Thread straps through footman loops and press hook and loop together. See figure 2.

Step 4. Bows. Slide bow halves (Item 11) together. Slip two bow halves into pocket at front of tonneau. Secure bow to body with 12-24 x 1 1/2" slotted machine screws (Item 12) through bow halves and into original hard top mounting clips. Secure remaining bows to body using same procedure. See figure 2. Zip front of tonneau to cab curtain.



Step 5. Tonneau Installation. Find center of tailgate aluminum and mark a line. Pull center snap on rear curtain down to meet center line on tailgate aluminum. Mark and drill 3/16" hole. Install machine screw stud and snap center snap on the top to the stud. Continue installing studs alternating from left to right and pulling on rear of tonneau until smooth when finding stud positions. The first stud location for body aluminum should be approximately 1 1/4" from the end of body aluminum centered from top to bottom. Mark drill and install a stud at this point using same method as above. Continue installing studs working from rear to front alternating left to right after each stud installation. The two snaps at the front of the tonneau are gypsy studs. These snaps will snap to body aluminum at front of vehicle where the cab curtain and tonneau meet. Snap tonneau to body aluminum and cab curtain to gypsy stud on tonneau. These gypsy studs allow for use of each piece individually or together.

PARTS IDENTIFICATION

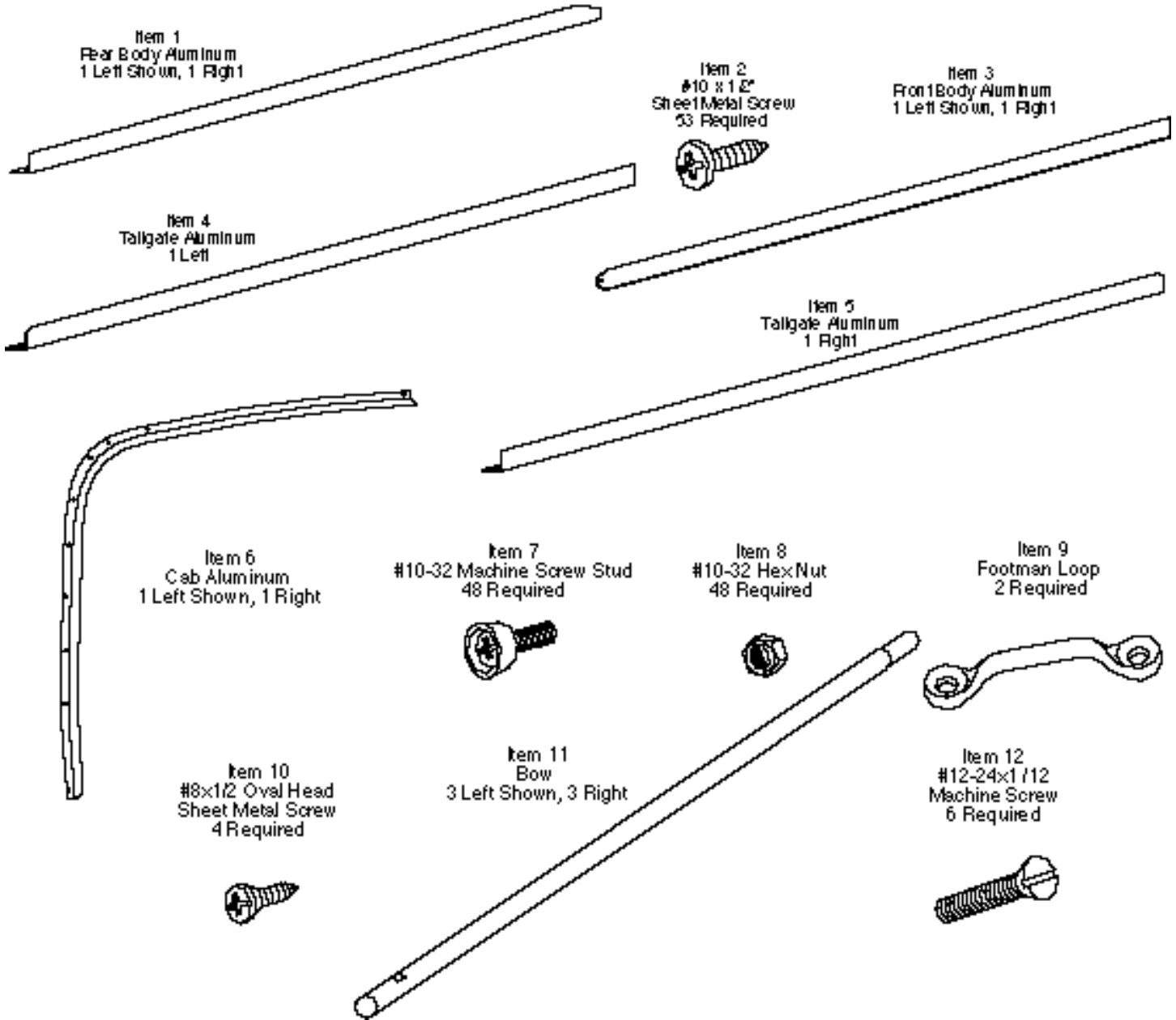

CARE INSTRUCTIONS

Convertible tops and accessories require special care if you want to get the maximum usage and enjoyment from them. The following recommendations, if followed carefully, can extend the life of your top or accessory.

1. Hand wash using a mild non-detergent soap such as Ivory. Use a nonabrasive cloth or sponge. Rinse thoroughly.
2. **DO NOT** wash in direct sunlight and avoid automatic car washes.
3. When your top is clean, we recommend using "303 Protectant" on both the vinyl top and windows. This product contains a sunscreen that helps protect from the sun's damaging rays. Stay away from products containing alcohol as it will cause the fabric and windows to lose their elasticity, thus reducing the life of your top or accessory. If you are unable to locate "303 Protectant", please call 1-800-223-4303 for a distributor near you.
4. Direct sunlight and heat are the biggest enemies of the windows. Park in the shade whenever possible.
5. **DO NOT** open or roll up windows at temperatures below 45 degrees F. This could cause them to crack or break.
6. **NEVER** use ice scrapers or snow brushes on vinyl windows.

WARRANTY INFORMATION:

Specialty Top Co. warrants to the original purchaser of any product it manufactures, that the product will be free of defects in material or workmanship for a period of 90 days from date of purchase. Such obligations under this warranty shall be limited to the **repair or replacement**, at Specialty's discretion, of any assembly or parts which upon examination by Specialty Top Co. proves to be defective. All defective items must be returned with proof of purchase to Specialty Top Co., 200 East 64th Avenue, Denver, Colorado 80221, freight prepaid. This warranty does not cover damage resulting from abuse, misuse, alteration, accident or damage in transit. Specialty's obligations under this warranty are limited to the aforementioned repair or replacement of warranty defects for which the return authorization has been received during the warranty period, and **SPECIALTY TOP CO. SHALL NOT BE LIABLE FOR ANY INCIDENTAL OR CONSEQUENTIAL DAMAGES ARISING FROM BREACH OF THIS OR ANY IMPLIED WARRANTY.**

Some states do not allow the exclusion or limitation of incidental or consequential damages, so the above limitation or exclusion may not apply to you. This warranty gives you specific legal rights, and you may also have other rights which may vary from state to state.

If you need assistance or further information, you may contact Specialty Top Co. at 1-866-487-9944 between the hours of 8:00 AM and 5:00 PM, Monday through Friday, Mountain Standard Time.