



# SPECIALTY TOP CO.

## INSTALLATION INSTRUCTIONS

### BRONCO FAST TRAC TOP

#### PART #331-210

#### BRONCO 1966-1977

Thank you for purchasing Specialty's Convertible Top for your Bronco. It has been designed for great fit and long wear. Please read and follow, precisely, all installation instructions provided when installing top. Failure to do so may result in a poor fitting top and could place occupants in a potentially hazardous situation.

#### TOOLS REQUIRED:

- |                 |                         |
|-----------------|-------------------------|
| 3/8" WRENCH     | 7/16" WRENCH            |
| 1/2" WRENCH     | #2 PHILLIPS SCREWDRIVER |
| 1/8" DRILL BIT  | 9/64" DRILL BIT         |
| 5/32" DRILL BIT | 3/8" DRILL BIT          |
| ELECTRIC DRILL  | 8' TAPE MEASURE         |
| ALCOHOL         |                         |

**Windshield Adjustment.** If your windshield frame is improperly adjusted, the top will not fit or function properly. Measure from the inside edge of windshield frame to the inside edge of tailgate as shown in figure 1. For a proper fit this measurement should be 83 3/4" to 84". If it measures slightly more than 84" the tension from the top may pull it into position. If it measures less than 83 3/4" you will need to loosen the hand bolts on both sides of windshield frame and place shims under windshield frame and retighten bolts.

#### INSTALLATION TIPS

Before you begin installing this top, here are a few tips to make installation easier.

This top should be installed where the temperature is above 72 degrees Fahrenheit. Below this temperature, the top may contract making it difficult to install.

It is normal for a top to contract and wrinkle when stored in the shipping carton. The top will relax and wrinkles will disappear within a few days of installation as fabric adjusts to shape of mounting hardware.

#### INSTALLATION PROCEDURES:

On page of this instruction manual there is an assembly drawing. Please refer to it for identification of parts and assembly assistance. Also refer to page to assure that are parts are include in your kit.

Figure 1

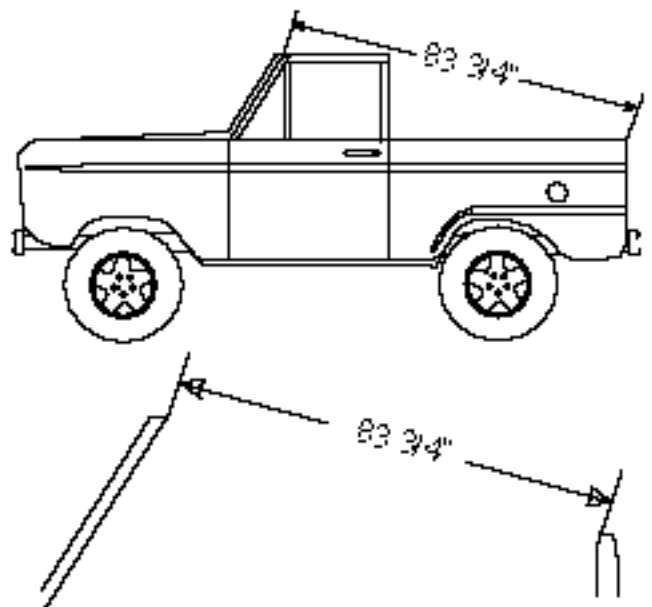

**Step 2. Body aluminum.** Mount body aluminum (Item 1) to the top edge of the body with notch to inside of vehicle. Locate body aluminum 1 1/8" from the inside edge of body and 2 1/8" from the drop in door opening. Body aluminum should be parallel to vehicle body front to rear. Place 5/16-18 hex bolts (Item 2) through 5/16" flat washer (Item 3) original hard top mounting holes. Secure with 5/16" flat washers and 5/16-18 hex nuts (Item 4). Drill 5/32" hole in top of body using rear hole in body aluminum as a template. Install #14 x 1/2" sheet metal screw (Item 6) to secure rear of body aluminum to vehicle. See figure 2.

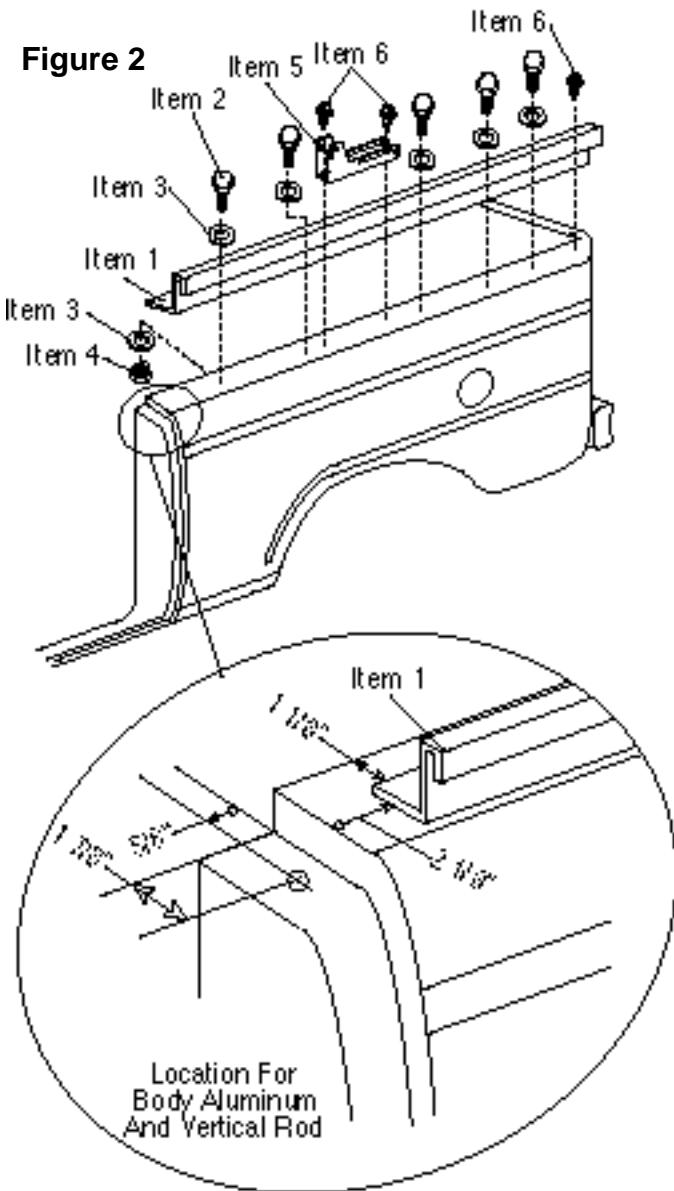

**Step 4. Bows.** Secure bow release bracket (Item 7) to bow mount by placing 1/4-20 x 1 3/4" hex head bolt (Item 8) through 1/4" flat washer (Item 9), then through one side of bow mount, the bow release bracket, the other side of bow mount and another 1/4" flat washer. Secure with 1/4-20 lock nut (Item 10). These items must pivot so do not over tighten. Repeat for other side. Place rear bow sleeves (Item 11) over rear bows (Item 12). Slide rear bow halves together. Mount rear bow into center set of holes in bow release bracket by placing 1/4-20 x 1 1/2" hex head bolt (Item 13) through one side of release bracket, rear bow and then through the other side of release bracket. Secure with 1/4-20 lock nut (Item 10). Again these items must pivot so do not over tighten. Repeat for other side. Slide front bow sleeves (Item 14) over front bow halves (Item 15). Place front bow into front slot in bow mount so that the large holes in bow are facing towards the front of vehicle. Secure front bow to bow mount with 1/4-20 x 1 3/4" hex head bolt through 1/4" flat washer one side of bow mount, front bow, the other side of bow mount, and another 1/4" flat washer. Secure with 1/4-20 lock nut. Again these items must pivot so do not over tighten ten. Repeat for other side. See figure 3.

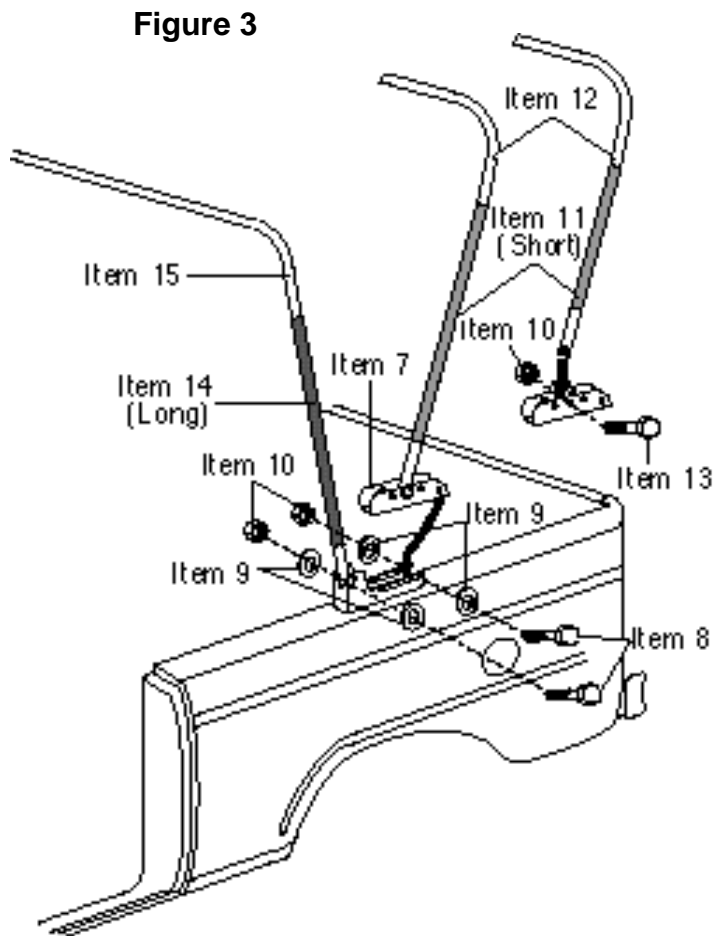

**Step 3. Bow Mount.** Fit bow mount (Item 5) into the forward corner of notch in body aluminum. Using bow mount as a template, mark and drill two 5/32" holes, one at the front inside of bracket and one at the rear inside of bracket. Secure with #14 x 1/2" hex head sheet metal screws (Item 6). Repeat for the other side. See figure 2.

**Step 5. Riser.** Position riser (Item 16), on top of windshield frame, centering it from side to side. Place 5/16-18 x 3/4" hex bolts (Item 2) through 5/16" flat washer (Item 3), the riser windshield frame and 5/16" star washer (Item 17). Secure with 5/16-18 hex nut (Item 4). On both ends of the riser you will need to mount horizontal rod brackets (Item 18). There is one left and one right. The large hole in the bracket should face the rear of and to the outside of the vehicle as shown in figure 4. These brackets sit on top of riser and are attached with the same bolts that secure the riser to the windshield frame. See figure 4.

**Step 7. Footman Loop.** A footman loop (Item 27) will need to be installed at rear corner of body. Place footman loop at an angle on rear corner of body. Using footman loop as a template, mark and drill 1/8" holes. Secure footman loop to body with #8 x 1/2" sheet metal screws (Item 28). Clean tailgate with alcohol and water solution where hook on bottom of rear curtain and tailgate meet. Attach self adhesive loop (Item 26) at this point. See illustration G on page 5.

**Step 6. Windshield Wiper Motor Bracket** On certain models a windshield wiper motor bracket (Item 19) will need to be installed to lower the windshield wiper motor and keep it from protruding into the top. Remove wiper arm from motor. Remove motor from original bracket and bracket from windshield frame. Install windshield wiper motor bracket provided in the kit into original holes. Turn motor over and install into wiper motor bracket using original fasteners. Reattach wiper arm making sure that wipers are in the correct position. See figure 4.

**Step 8. Tailgate Clip.** Measure 3 1/4" from edge of tailgate and mark for location of tailgate clip (Item 29). Using tailgate clip as a template mark and drill 1/8" holes making sure that there is a 3/16" gap between top of tailgate and bottom of tailgate clip. Secure tailgate clip to tailgate with #10 x 1/2" sheet metal screws (Item 30). See illustration H on page 5.

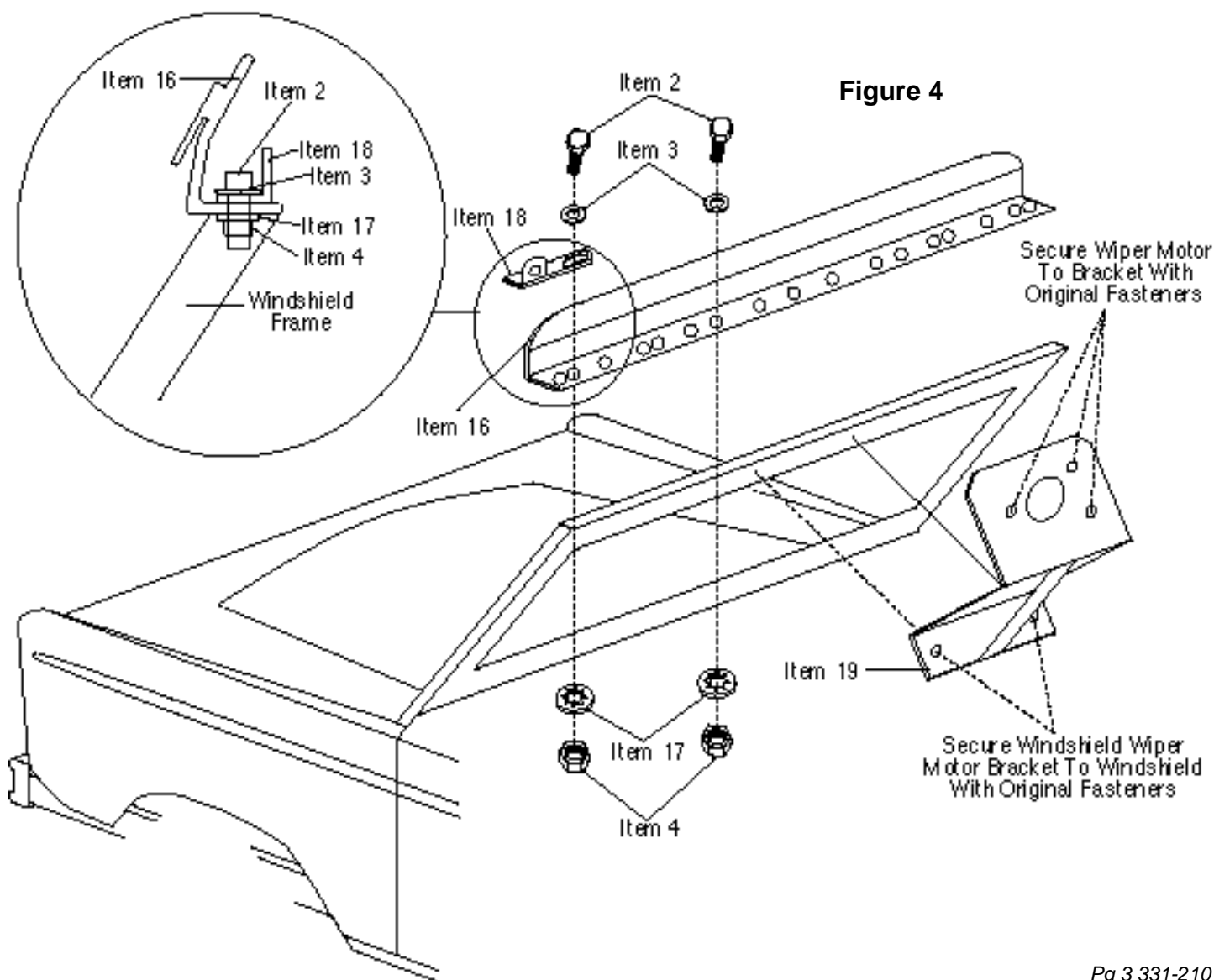

## FABRIC INSTALLATION

**Step 1. Horizontal And Vertical Rods.** Position front of horizontal rods (Item 20) into horizontal rod brackets mounted on windshield riser See figure A. Pull front bow forward and place rear of horizontal rod into hole in bow. See figure B. It is recommended that you hold the vertical rod in position, to assure proper alignment, prior to drilling holes. This should be done with the door closed. You will need to remove a phillips screw from the weather stripping on door opening and either cut the large portion away or leave it intact, but to one side, for reinstallation of hard top. Drill 3/8" holes as noted on page 2, figure 2. Remove wing nut (Item 22), 5/16" flat washer (Item 23) and 5/16" x 3/4" carriage bolt (Item 24) from horizontal rod. Position end of vertical rod (Item 21) into hole drilled in top edge of door opening. Place 5/16" x 3/4" carriage bolt through square hole in horizontal rod and slotted hole in vertical rod. Place 5/16" flat washer on next and secure with 5/16" wing nut. See figure C.

**Step 2. Channel Installation.** Place top on hood of vehicle, vinyl side down. Slide sewn in rope into channel (Item 25). See figure D. Slip channel into windshield riser Flip top up and over front bow. Snap rear bow flap to rear bow. See figure E.

**Step 3. Top Installation.** Pull to the rear and down on rear bottom corners of side panels until 2 1/2" pieces of plastic are fully engaged on rear of belt rail. See illustration I on page 6. Install long plastic pieces, working from rear to front, until all are fully engaged. Lock bows into position as shown in illustration F on page 5. Insert tailgate retainer (Item 32) in fabric loop in bottom of rear curtain. See illustration M on page 6. Slip between tailgate clips and the tailgate. Thread hold down straps through footman loops, buckle and tighten only enough to hold rear bow in place. If over tightened, it could cause the fabric to tear. Close zippers on both sides of rear curtain. Fasten hook on side panels to loop on rear curtain. See illustration J on Page 6.

**Step 4. Horizontal And Vertical Rod Flaps.** Wrap vertical rod flap around vertical rod and press hook and loop together at side curtain. Wrap horizontal rod flap around horizontal rod and press hook and loop together See illustration K on page 6.

**Step 5. Windshield Snap Studs.** Pull down on tab at front side of top. Mark and drill for best position of snap stud. Mark and drill 9/64" hole. Install 3/8" sheet metal screw stud (Item 31). Repeat for other side. See illustration L on page 6.

**Rolling Up Side Panels.** It is possible to roll up your side curtains to provide more ventilation in your vehicle. Prior to rolling side or rear curtains you must first make sure that windows are clean. If not properly cleaned dirt will scratch them reducing top life. To clean windows, wash them with a mild non-detergent soap and water. You may want to place a soft cloth between retaining straps and windows to prevent marring of window glass. To roll up side panels, unzip rear curtain zippers, unlock rear bow, unfasten side panels, unfasten hook and loop from vertical rod and roll up side panels. Secure with retaining straps on top. Lock rear bow, buckle and tighten hold down straps. To roll up rear curtain, remove tailgate retainer and follow the same procedure. You will not have to unfasten hook and loop from vertical rod to roll up the rear curtain. You may roll up both side and rear curtains if you wish. See figure N.

Figure N

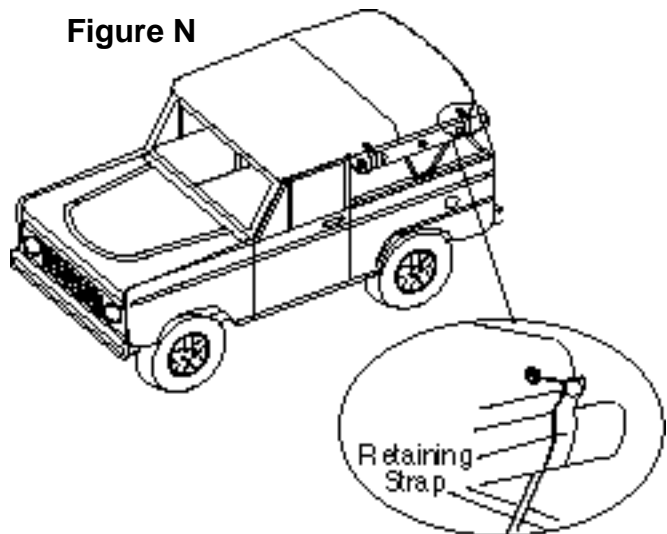

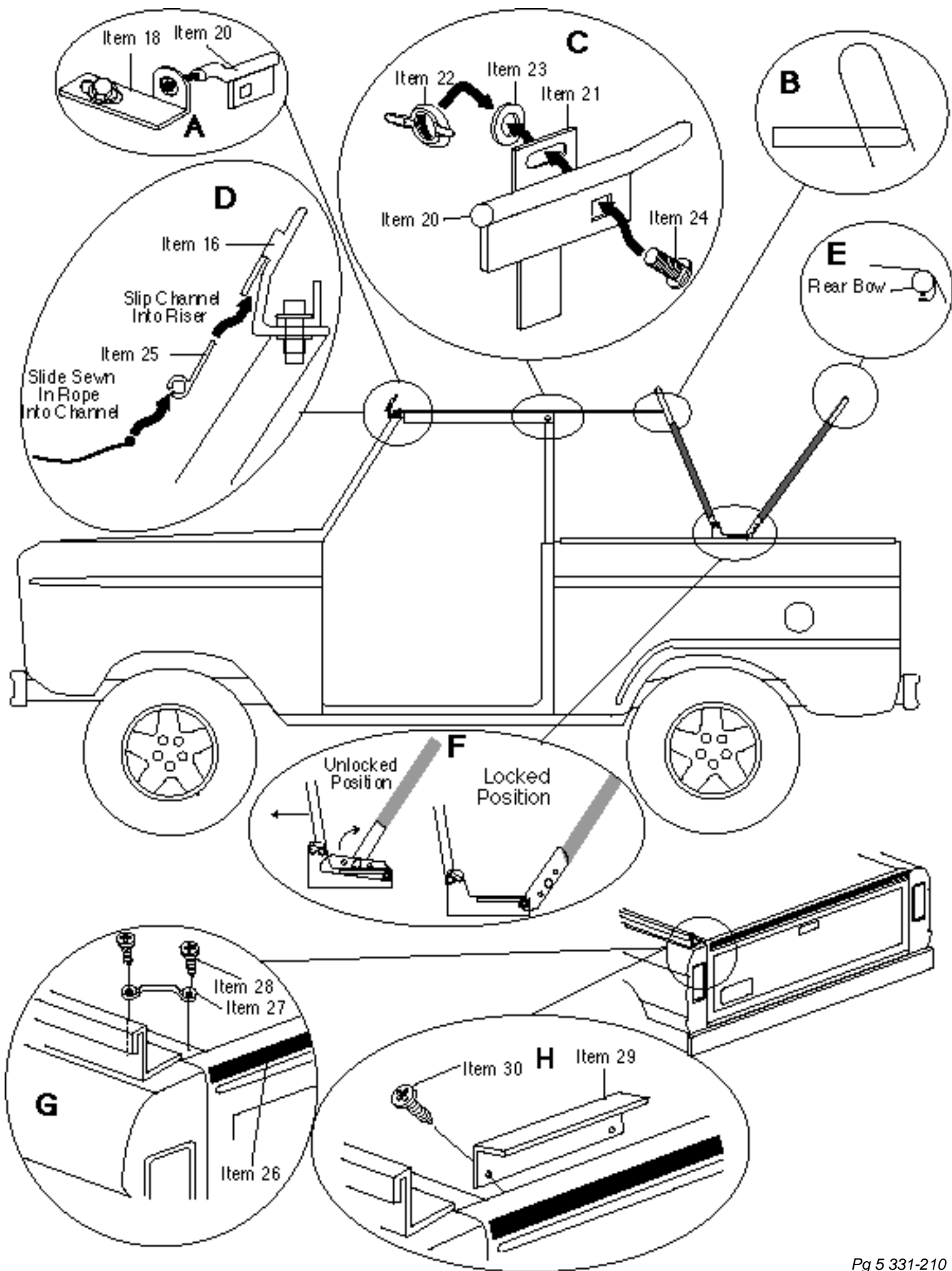

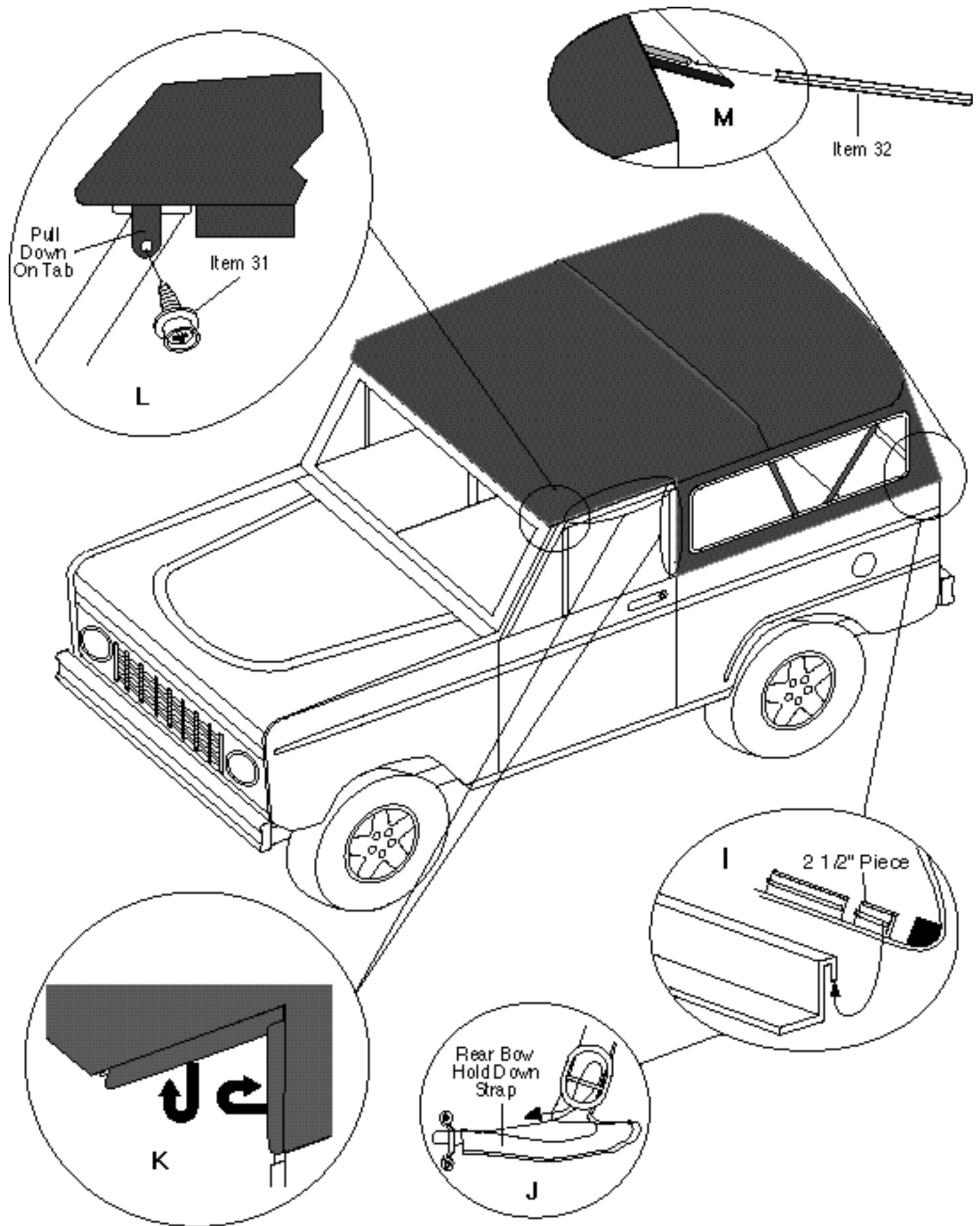

# Parts Identification And Requirements

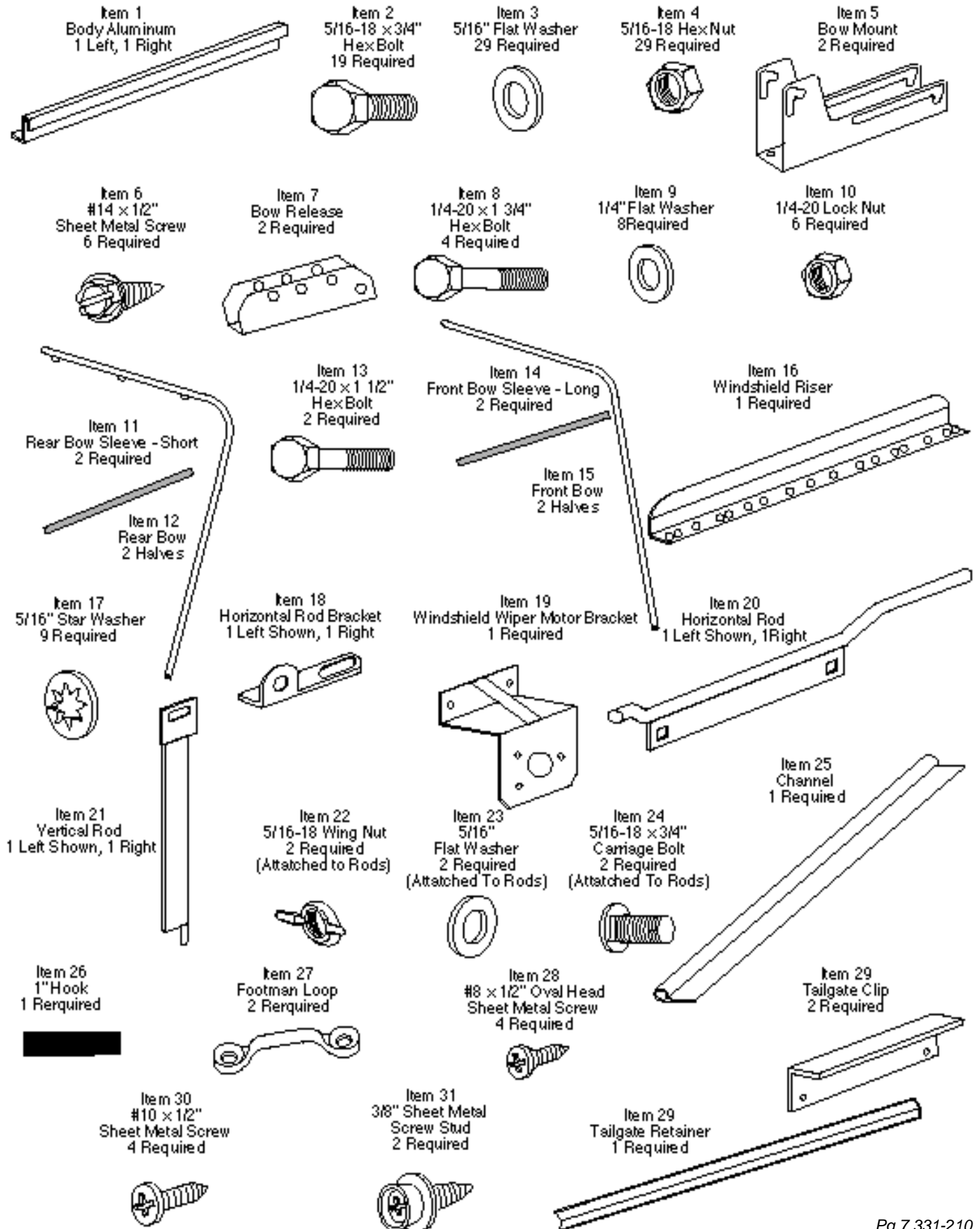

## FOLDING INSTRUCTIONS

**Step 1.** Unlock rear bow, unfasten all sewn in plastic and unwrap horizontal and vertical rod flaps. Lift side curtains up and fold them on top of bows.

**Step 2.** Lift rear curtain up and fold it on top of bows.

**Step 3.** Remove horizontal and vertical rods.

**Step 4.** Slip channel out of windshield riser. Fold front of top to the rear over bows.

**Step 5.** As you pull the front of top and bows to the rear of vehicle, let the top sag in between bows.

**Step 6.** Continue to lay bows down and let them come to rest on top of tailgate. A convertible boot is available from your local dealer to enclose your top, preventing top from becoming dirty while in the down position.

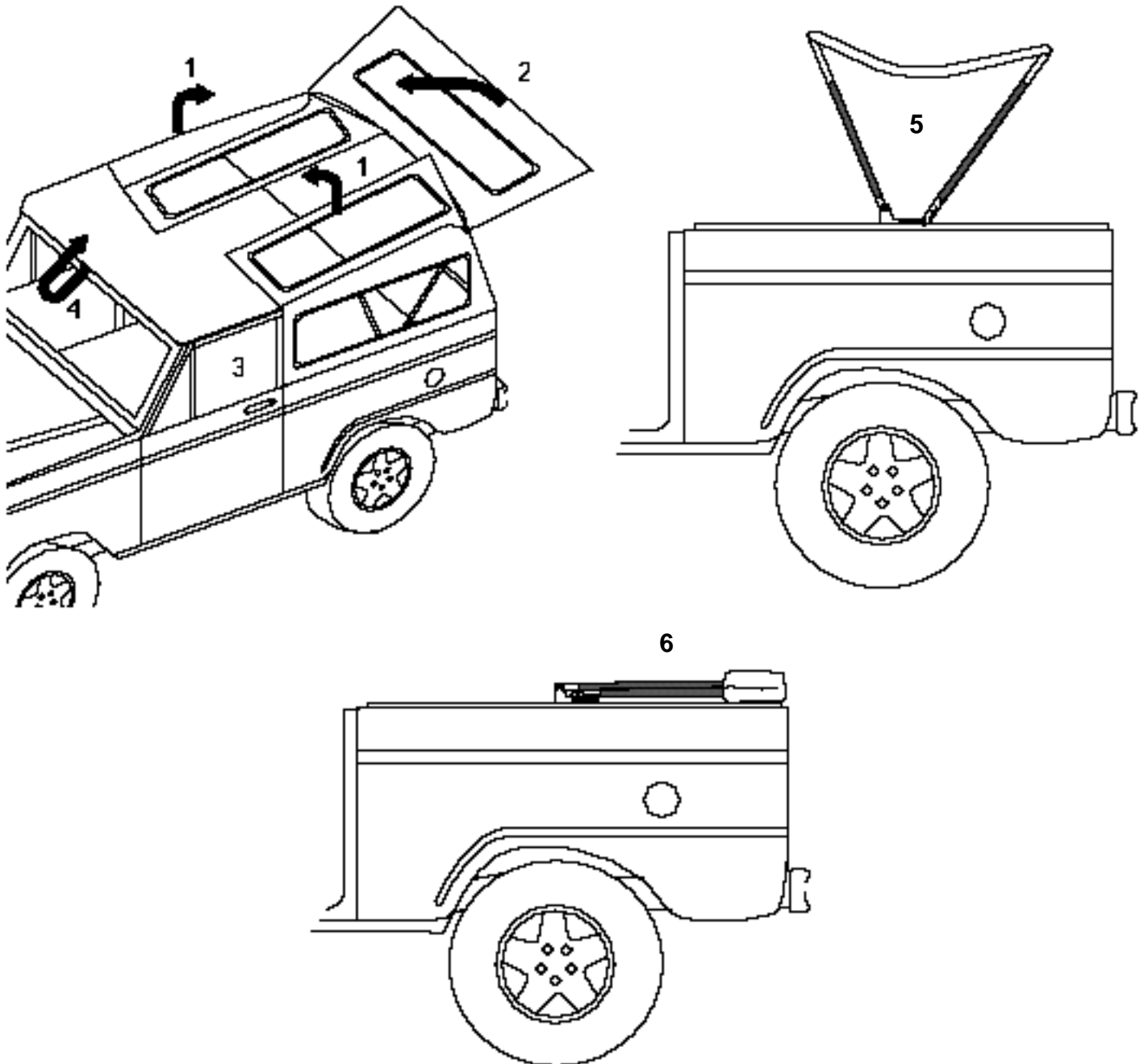



## CARE INSTRUCTIONS

Convertible tops and accessories require special care if you want to get the maximum usage and enjoyment from them. The following recommendations, if followed carefully, can extend the life of your top or accessory.

1. Hand wash using a mild non-detergent soap such as Ivory. Use a nonabrasive cloth or sponge. Rinse thoroughly.
2. **DO NOT** wash in direct sunlight and avoid automatic car washes.
3. When your top is clean, we recommend using "303 Protectant" on both the vinyl top and windows. This product contains a sunscreen that helps protect from the sun's damaging rays. Stay away from products containing alcohol as it will cause the fabric and windows to lose their elasticity, thus reducing the life of your top or accessory. If you are unable to locate "303 Protectant", please call 1-800-223-4303 for a distributor near you.
4. Direct sunlight and heat are the biggest enemies of the windows. Park in the shade whenever possible. If you must park in the sunlight, rotate the direction that you park every few days so all windows get even exposure.
5. Our tops are designed so that you may roll up and/or store the rear curtain and side curtains. To prevent scratching of the windows, be sure that windows are completely clean and free of dust particles. Even a little dirt will badly scratch the windows. You may want to use a soft cloth when rolling up or storing your windows. Heat may build up on rolled up windows, so be sure to unroll them frequently. If you roll up the windows at the beginning of summer and leave them, they may be ruined by fall.
6. **DO NOT** open or roll up windows at temperatures below 45 degrees F. This could cause them to crack or break.
7. **NEVER** use ice scrapers or snow brushes on vinyl windows.

## WARRANTY INFORMATION:

Specialty Top Co. manufacturing warrants to the original purchaser of any product it manufactures, that the product will be free of defects in material or workmanship for a period of 90 days from date of purchase. Such obligations under this warranty shall be limited to the **repair or replacement**, at Specialty's discretion, of any assembly or parts which upon examination by Specialty Top Co. proves to be defective. All defective items must be returned with proof of purchase to Specialty Top Co. Manufacturing, 200 East 64th Avenue, Denver, Colorado 80221, freight prepaid. This warranty does not cover damage resulting from abuse, misuse, alteration, accident or damage in transit. Specialty's obligations under this warranty are limited to the aforementioned repair or replacement of warranty defects for which the return authorization has been received during the warranty period, and **SPECIALTY TOP CO. SHALL NOT BE LIABLE FOR ANY INCIDENTAL OR CONSEQUENTIAL DAMAGES ARISING FROM BREACH OF THIS OR ANY IMPLIED WARRANTY.**

Some states do not allow the exclusion or limitation of incidental or consequential damages, so the above limitation or exclusion may not apply to you. This warranty gives you specific legal rights, and you may also have other rights which may vary from state to state.

If you need assistance or further information, you may contact Specialty Top Co. at 1-866-487-9944 between the hours of 8:00 AM and 5:00 PM, Monday through Friday, Mountain Standard Time.