



SPECIALTY TOP CO.

INSTALLATION INSTRUCTIONS JEEPSTER COMMANDO 1965-1973 PART #111-010

Thank you for purchasing Specialty's Convertible Top for your Jeep® vehicle. It has been designed for great fit and long wear. Please read and follow, precisely, all installation instructions provided when installing top. Failure to do so may result in a poor fitting top and could place occupants in a potentially hazardous situation.

TOOLS REQUIRED:

3/8" WRENCH	7/16" WRENCH
1/2" WRENCH	#2 PHILLIPS SCREWDRIVER
1/8" DRILL BIT	5/32" DRILL BIT
3/8" DRILL BIT	ELECTRIC DRILL
8' TAPE MEASURE	RUBBING ALCOHOL

INSTALLATION TIPS

Before you begin installing this top, here are a few tips to make installation easier.

This top should be installed where the temperature is above 72 degrees Fahrenheit. Below this temperature, the top may contract making it difficult to install.

It is normal for a top to contract and wrinkle when stored in the shipping carton. The top will relax and wrinkles will disappear within a few days of installation as fabric adjusts to shape of mounting hardware.

INSTALLATION PROCEDURES:

On page 3 of this instruction manual there is an assembly drawing. Please refer to it for identification of parts and assembly assistance. Also refer to page 4 to assure that all parts are included in your kit.

Step 1. Bow Mount. Prior to drilling, check under side of body edge for wiring. Position front of bow mount (Item 1) 25 1/2" from door opening. With bow mount flush with outside edge of body, mark and drill two 5/32" holes using bow mount as a template. Use only one front hole and one rear hole to mount bow mount. Secure to body with #14 x 1/2" sheet metal screws (Item 2). See figure 1.

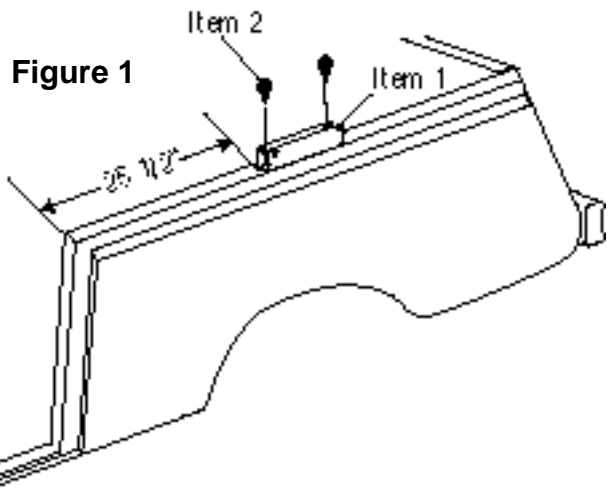

Step 2. Bows. Secure bow release (Item 3) to rear set of holes in bow mount by placing 1/4-20 x 1 1/2" hex head bolt (Item 4) through one side of bow mount, bow release bracket and through other side of bow mount. Secure with 1/4-20 lock nut (Item 5). These items must pivot so do not over tighten. Repeat for the other side. Place long bow sleeve (Item 6) over rear bow halves (Item 7). Place rear bow into bow release bracket. Place 1/4-20 x 1 1/2" hex head bolt (Item 4) through center hole in bow release bracket, rear bow and through other side of bow release bracket. Secure with 1/4-20 lock nut (Item 5). Again these items must pivot so do not over tighten. Place short bow sleeve (Item 8) over front bow halves (Item 9). Place front bow into front holes in bow mount with large holes in front bow are facing forward. Secure to bow mount by placing 1/4-20 x 1 1/2" hex head bolt through one side of bow mount, front bow and through the other side of bow mount. Secure with 1/4-20 lock nut. Again these items must pivot so do not over tighten. Repeat for the other side. See figure 2.

Figure 2

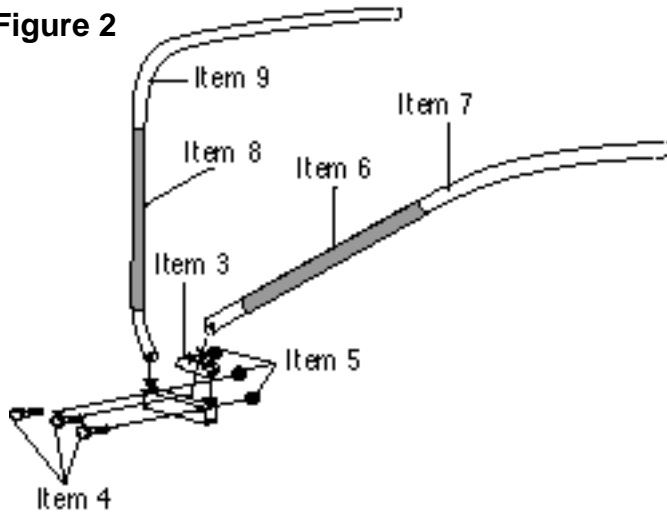

Step 3. Door Framing Rods. With doors closed and windows rolled up, position door framing rods (Item 10) around windows. Mark and drill a 3/8" hole in windshield frame 1/2" above window using door framing rod as a guide. The window should not flex when coming in contact with the rod when closed. See figure 3-A. Drill another 3/8" hole in door opening using the door framing rod as a guide. This hole should be approximately 3/8" to the rear of the door opening and 1/2" from outside edge of body. Again the window glass should just make contact with the door framing rod. Place front of rod into hole in windshield frame, the rear of the rod into hole at door opening. Pull the front bow forward and place upper rear of rod into large hole in front bow. Repeat for the other side.

Step 4. Windshield Slot. Place windshield slot (Item 11) over the top of windshield frame. Secure to windshield frame with original hard top mounting bolts into original mounting holes. This will form a small slot for the flat part of windshield channel (Item 12) to slip into. See figure 3-A.

Rolling Up Side Panels. It is possible to roll up your side panels and rear curtain to provide more ventilation in your vehicle. Prior to rolling up side panels or rear curtain you must first make sure that windows are clean. If not properly cleaned, dirt will scratch them reducing the life of your top. It is also recommended that you use a soft cloth between the windows and the retaining straps to prevent them from marring the glass. To clean the windows, wash them with a mild non-detergent soap and water. To roll up side panels first unzip rear curtain and unlock rear bow. Unfasten side panel from body aluminum, roll up side panel and secure with retaining strap. See figure 4. Snap bow retaining strap to outside snap on rear bow. See figure 3-F. Wrap retaining strap around rear bow. Lock rear bow and pull strap down to a snap at rear of vehicle to retain tension on convertible top. Follow same procedure to roll up rear curtain. You may roll up both side panels and rear curtain if you wish.

INSTALLING VINYL TOP

Slide front of top into windshield channel (Item 12) and center it from side to side. See figure 3-A. Place flat portion of channel into slot on top of windshield frame. Pull top up and over support bows. Center the top from side to side on windshield frame. Snap rear bow flap to rear bow. See figure 3-C. Close zippers on rear curtain half way.

Pull rear bow into the locked position. See figure 3-D. Mark for position of first snap. Measure to find center of tailgate. Mark and drill 1/8" hole 1/2" down from top of tailgate edge on center line of tailgate. Install sheet metal screw stud (Item 13). Snap rear curtain to stud. Continue installing sheet metal screw studs using the rear curtain as a guide. Pull down and to the side to find the position for the next stud. Snap rear curtain to studs after each stud installation. Alternate left to right after each stud installation.

Pull side panels down and to the rear until zippers close properly. Mark and drill 1/8" holes using side panels as a guide. Install sheet metal screw studs. Snap last snap on side panels to stud just installed. Continue installing studs from the rear to the front snapping side panel snaps to studs as you go. Pull forward and down to find positions for studs using side panel snaps as a guide.

Pull forward and down on front of top at windshield frame to find location for sheet metal screw studs. Mark and drill 1/8" holes, using top as a guide. Install sheet metal screw studs. See Figure 3-B.

Figure 4

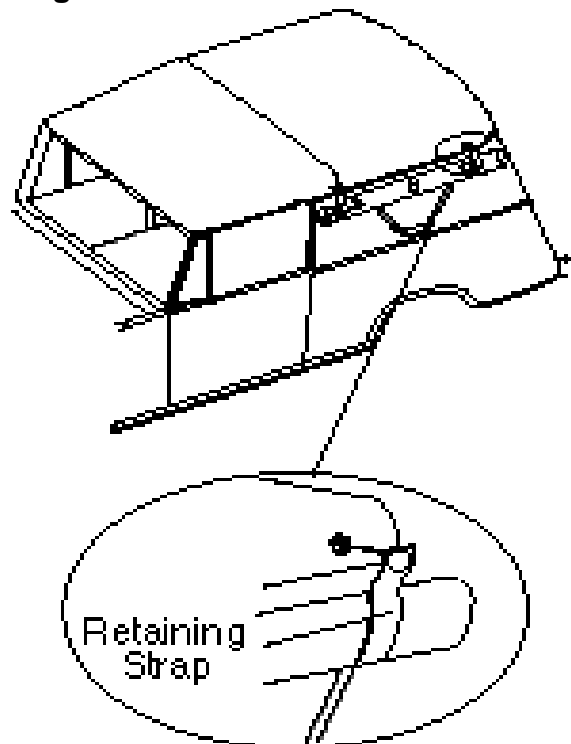

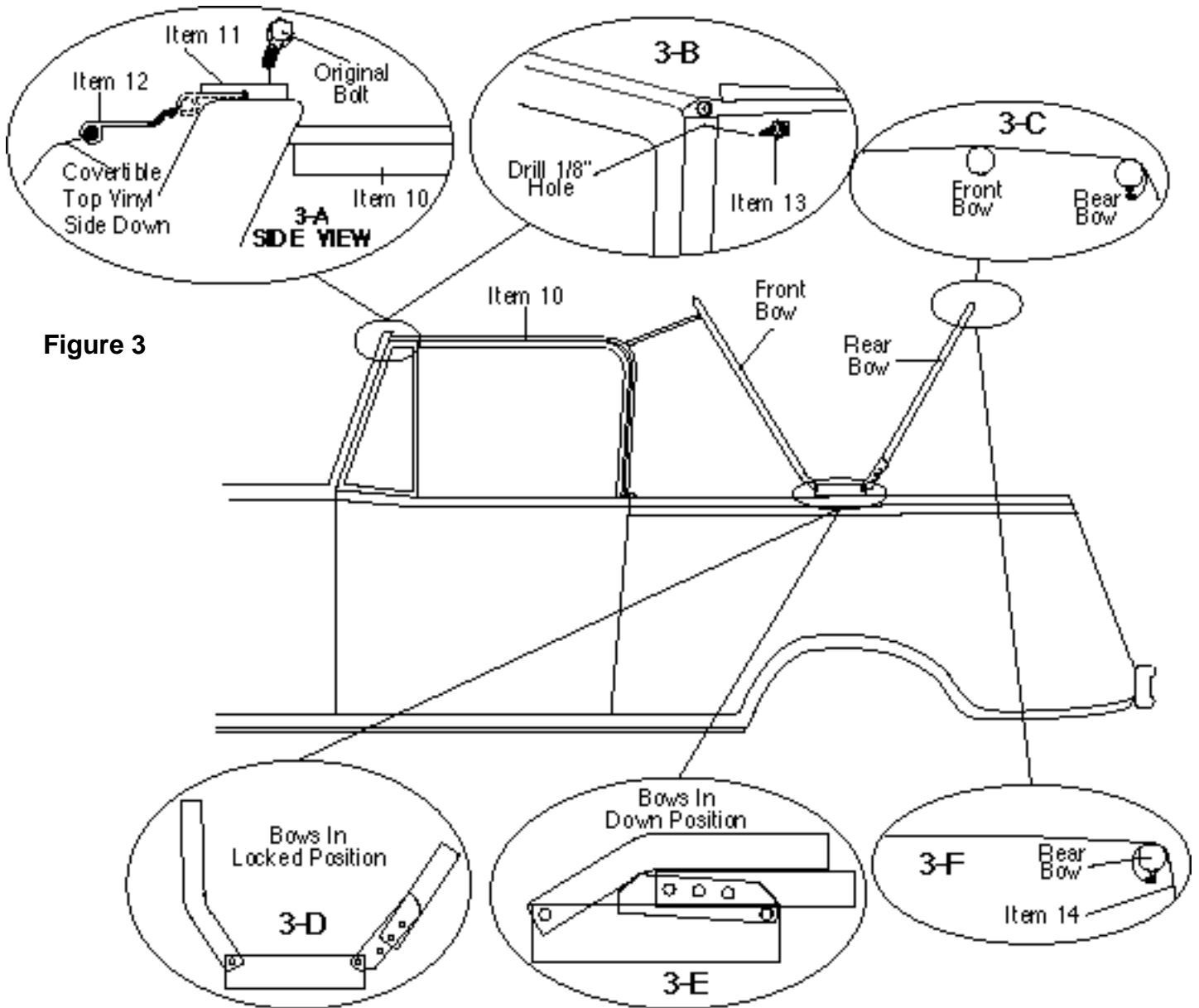

Figure 3

WARRANTY INFORMATION:

Specialty Top Co. manufacturing warrants to the original purchaser of any product it manufactures, that the product will be free of defects in material or workmanship for a period of 90 days from date of purchase. Such obligations under this warranty shall be limited to the **repair or replacement**, at Specialty's discretion, of any assembly or parts which upon examination by Specialty Top Co. proves to be defective. All defective items must be returned with proof of purchase to Specialty Top Co. Manufacturing, 200 East 64th Avenue, Denver, Colorado 80221, freight prepaid. This warranty does not cover damage resulting from abuse, misuse, alteration, accident or damage in transit. Specialty's obligations under this warranty are limited to the aforementioned repair or replacement of warranty defects for which the return authorization has been received during the warranty period, and **SPECIALTY TOP CO. SHALL NOT BE LIABLE FOR ANY INCIDENTAL OR CONSEQUENTIAL DAMAGES ARISING FROM BREACH OF THIS OR ANY IMPLIED WARRANTY.**

Some states do not allow the exclusion or limitation of incidental or consequential damages, so the above limitation or exclusion may not apply to you. This warranty gives you specific legal rights, and you may also have other rights which may vary from state to state.

If you need assistance or further information, you may contact Specialty Top Co. at 1-866-487-9944 between the hours of 8:00 AM and 5:00 PM, Monday through Friday, Mountain Standard Time.

Parts Identification And Requirements

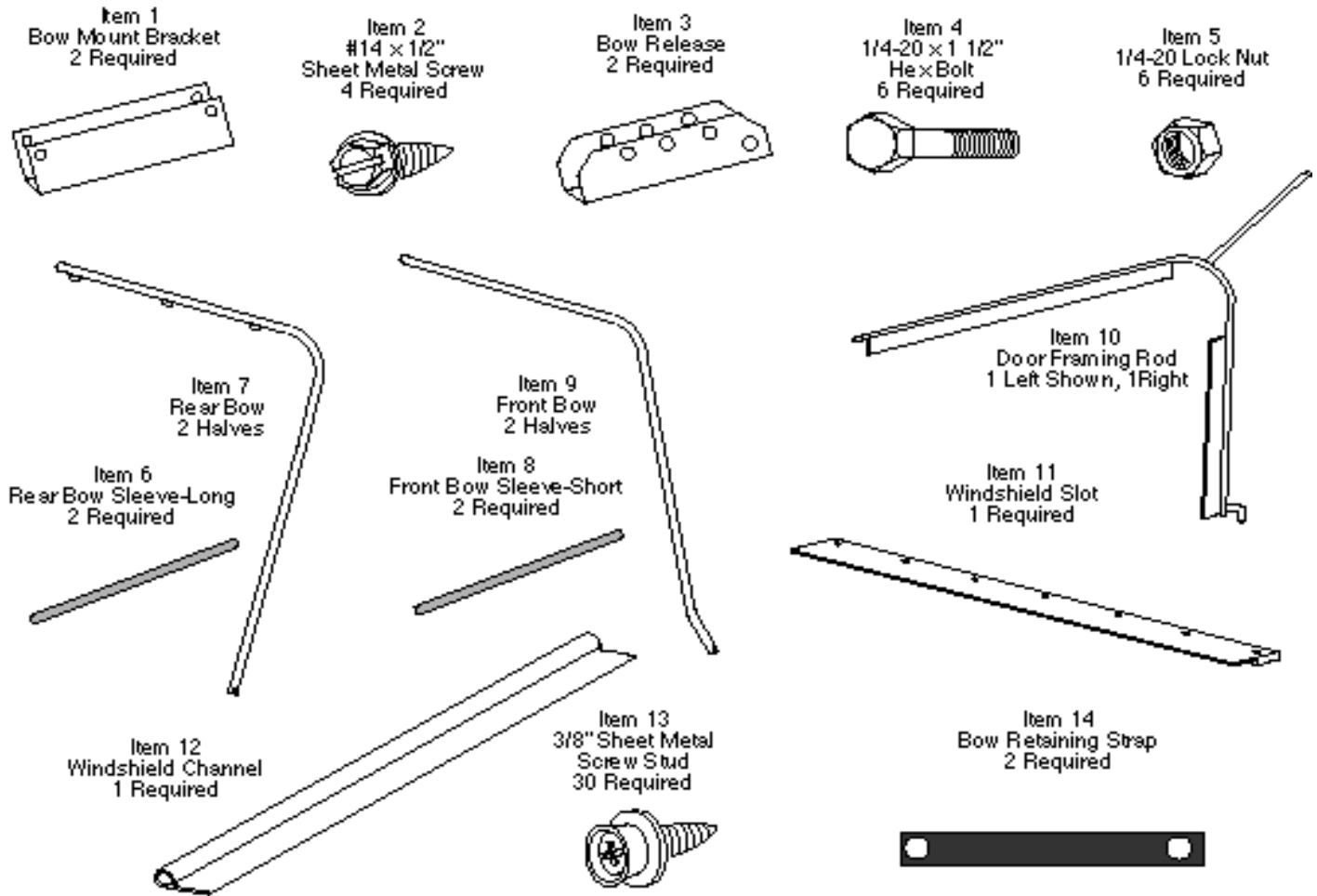

CARE INSTRUCTIONS

Convertible tops and accessories require special care if you want to get the maximum usage and enjoyment from them. The following recommendations, if followed carefully, can extend the life of your top or accessory.

1. Hand wash using a mild non-detergent soap such as Ivory. Use a nonabrasive cloth or sponge. Rinse thoroughly.
2. **DO NOT** wash in direct sunlight and avoid automatic car washes.
3. When your top is clean, we recommend using "303 Protectant" on both the vinyl top and windows. This product contains a sunscreen that helps protect from the sun's damaging rays. Stay away from products containing alcohol as it will cause the fabric and windows to lose their elasticity, thus reducing the life of your top or accessory. If you are unable to locate "303 Protectant", please call 1-800-223-4303 for a distributor near you.
4. Direct sunlight and heat are the biggest enemies of the windows. Park in the shade whenever possible. If you must park in the sunlight, rotate the direction that you park every few days so all windows get even exposure.
5. Our tops are designed so that you may roll up and/or store the rear curtain and side curtains. To prevent scratching of the windows, be sure that windows are completely clean and free of dust particles. Even a little dirt will badly scratch the windows. You may want to use a soft cloth when rolling up or storing your windows. Heat may build up on rolled up windows, so be sure to unroll them frequently. If you roll up the windows at the beginning of summer and leave them, they may be ruined by fall.
6. **DO NOT** open or roll up windows at temperatures below 45 degrees F. This could cause them to crack or break.
7. **NEVER** use ice scrapers or snow brushes on vinyl windows.

FOLDING INSTRUCTIONS

Step 1. Unlock rear bow and unfasten snaps. Lift side panel up and fold them on top of bows.

Step 2. Lift rear curtain up and fold on top of bows. Remove door framing rods.

Step 3. Remove channel from windshield slot. Fold front of top to the rear, over bows. Continue to fold top to the rear of vehicle as bows come to rest on tailgate. A convertible boot is available from your dealer to protect your top while in the down position.

