



SPECIALTY TOP CO.

INSTALLATION INSTRUCTIONS 76-91 BLAZER TONNEAU PART #553-055

Thank you for purchasing Specialty Top Company's tonneau and cab curtain for your Blazer. It has been designed for great fit and long wear. Please read and follow, precisely, all installation instructions provided when installing top. Failure to do so may result in a poor fitting top and could place occupants in a potentially hazardous situation.

TOOLS REQUIRED:

1/2" WRENCH ELECTRIC DRILL
1/8" DRILL BIT 8' TAPE MEASURE
#2 PHILLIPS SCREWDRIVER

INSTALLATION TIPS

Before you begin installing this tonneau and cab curtain, here are a few tips to make installation easier.

This top should be installed where the temperature is above 72 degrees Fahrenheit. Below this temperature, the top may contract making it difficult to install.

It is normal for a top to contract and wrinkle when stored in the shipping carton. The top will relax and wrinkles will disappear within a few days of installation as fabric adjusts to shape of mounting hardware.

INSTALLATION PROCEDURES:

On page 2 of this instruction manual there is an assembly drawing. Please refer to it for identification of parts and assembly assistance. Also refer to page 4 to assure that all parts are included in your kit.

Step 1. Body Aluminum. Mount rear body aluminum (Item 1) to the top edge of body. Place 5/16-18 x 3/4 hex bolts (Item 2) through 5/16" flat washers (Item 3), body aluminum and into existing holes in top of body. Butt front body aluminum (Item 3) to rear body aluminum and attach to the body using the same procedure as above. Front and rear body aluminum should be in line with each other from front to rear. See figure 1.

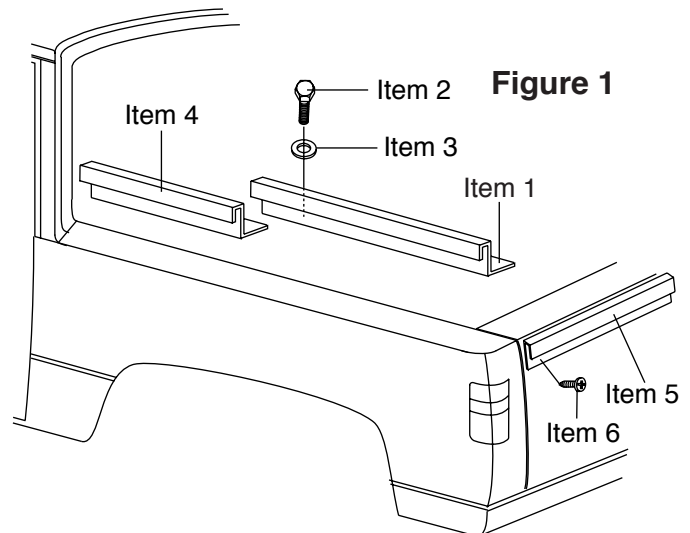

Step 2. Tailgate Aluminum. Mount tailgate aluminum (Item 5) to tailgate just above rolled edge (approximately 1/4" down from top edge of tailgate). Using tailgate aluminum as a template, mark and drill 1/8" holes. Secure to tailgate with #10 x 1/2" sheet metal screws (Item 6). Butt right side of tailgate aluminum to left side. Mark and drill holes and secure using same procedure as above. See figure 1.

Step 3. Cab Aluminum. Measure up 1 1/4" from top of body at rear of cab on the driver's side. This will be the starting point for mounting the cab aluminum. Place end of left cab aluminum (Item 7) at this point. Mark and drill 1/8" holes using cab aluminum as a template starting at the bottom and working your way to top center of cab. Install one #10 x 1/2" sheet metal screw (Item 6) at a time, keeping front of cab aluminum as far forward as possible and bending where needed to follow contour at rear of cab. See figure 2. Butt end of right cab aluminum to cab aluminum just installed and secure to cab using same procedure as above. See figure 2-A

Figure 2

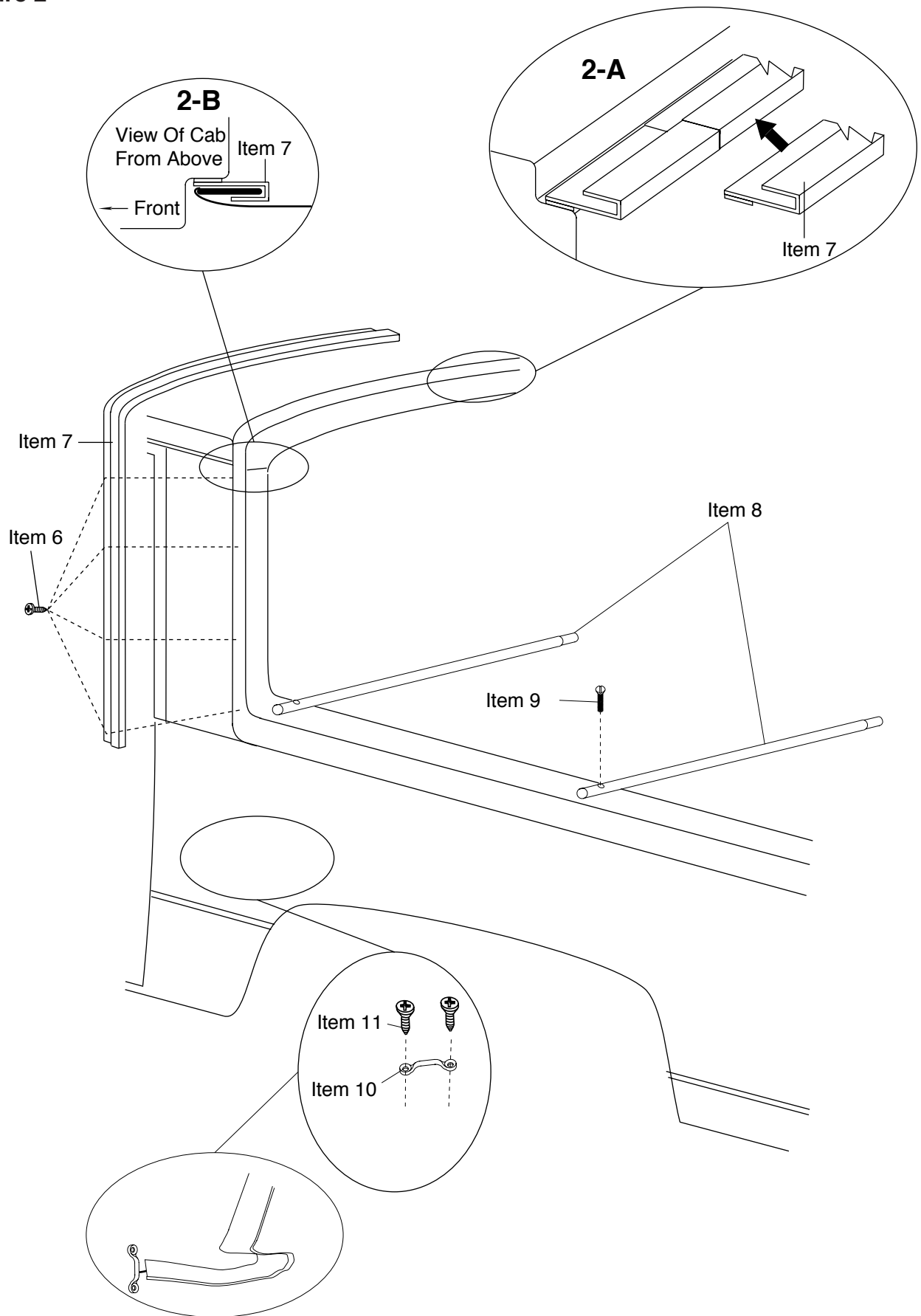

Step 4. Cab Curtain. Insert sewn in plastic on cab curtain, into slot in cab aluminum. See figure 2-B.

Step 5. Tonneau. Slip rear tonneau bow halves (Item 8) together. Place rear tonneau bow into position over mounting holes shared by front and rear body aluminum, making sure that the arc in the bow is up. Secure to body with 5/16 x 1 1/4" screws (Item 9). Slip front tonneau bow halves together. Place front tonneau bow through loop sewn at front of tonneau. Secure to body with 5/16 x 1 1/4" screw, making sure that the arc in the bow is up. Zip tonneau to cab curtain. Slip sewn in plastic into slot in tailgate aluminum. See figure 3-B. Pull down and to the outside to engage all of the K-locks into place on the body aluminum. See figure 3-A.

Step 6. Footman Loop. Place footman loops (Item 10) on the floor of vehicle in front of rear seat using straps at bottom of cab curtain as a guide. Mark and drill 1/8" holes using footman loops as a template. Secure to floor with #8 x 1/2" sheet metal screws (Item 11). Pull straps through footman loops and press hook and loop together. See figure 2.

Figure 3

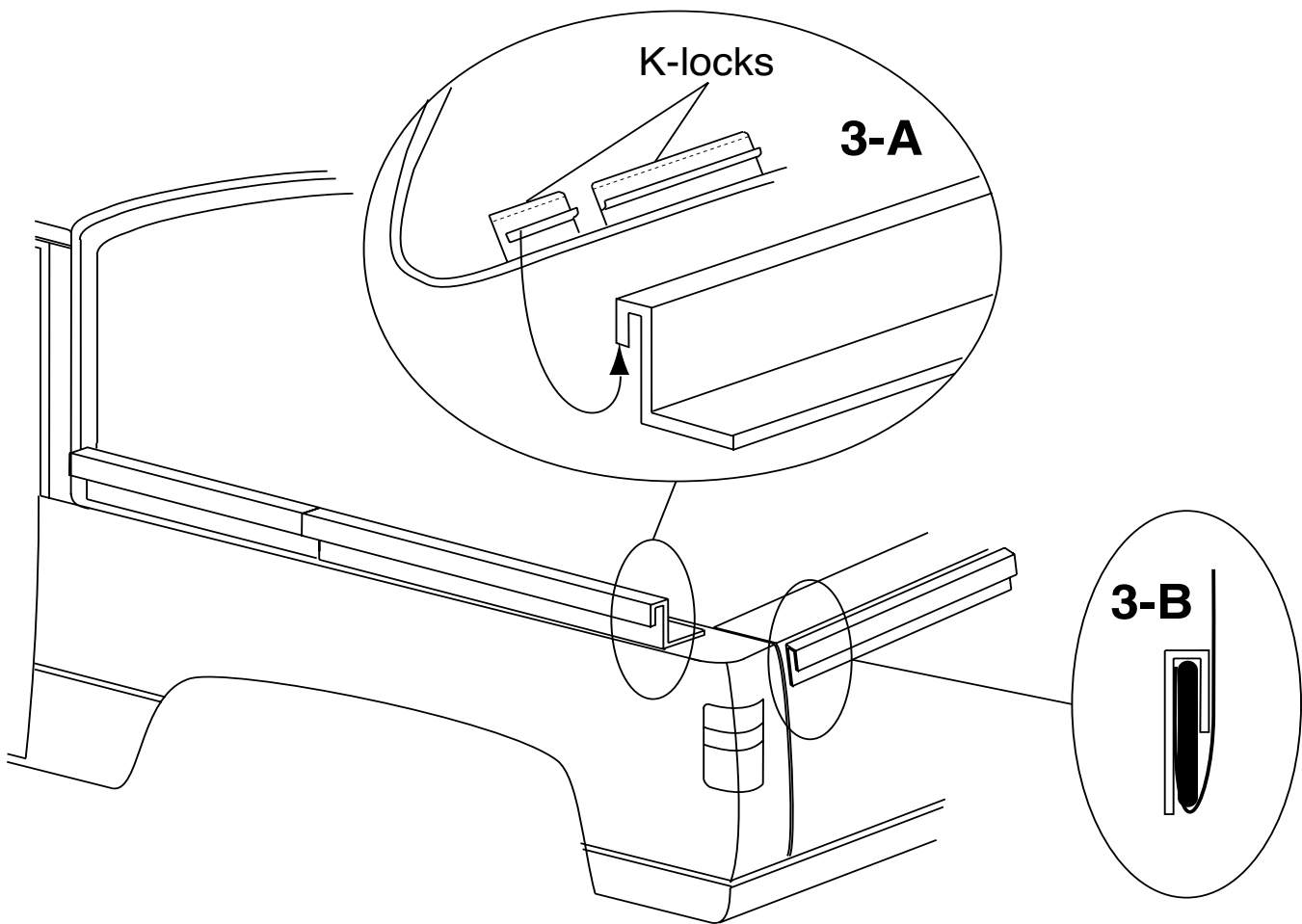

PARTS IDENTIFICATION

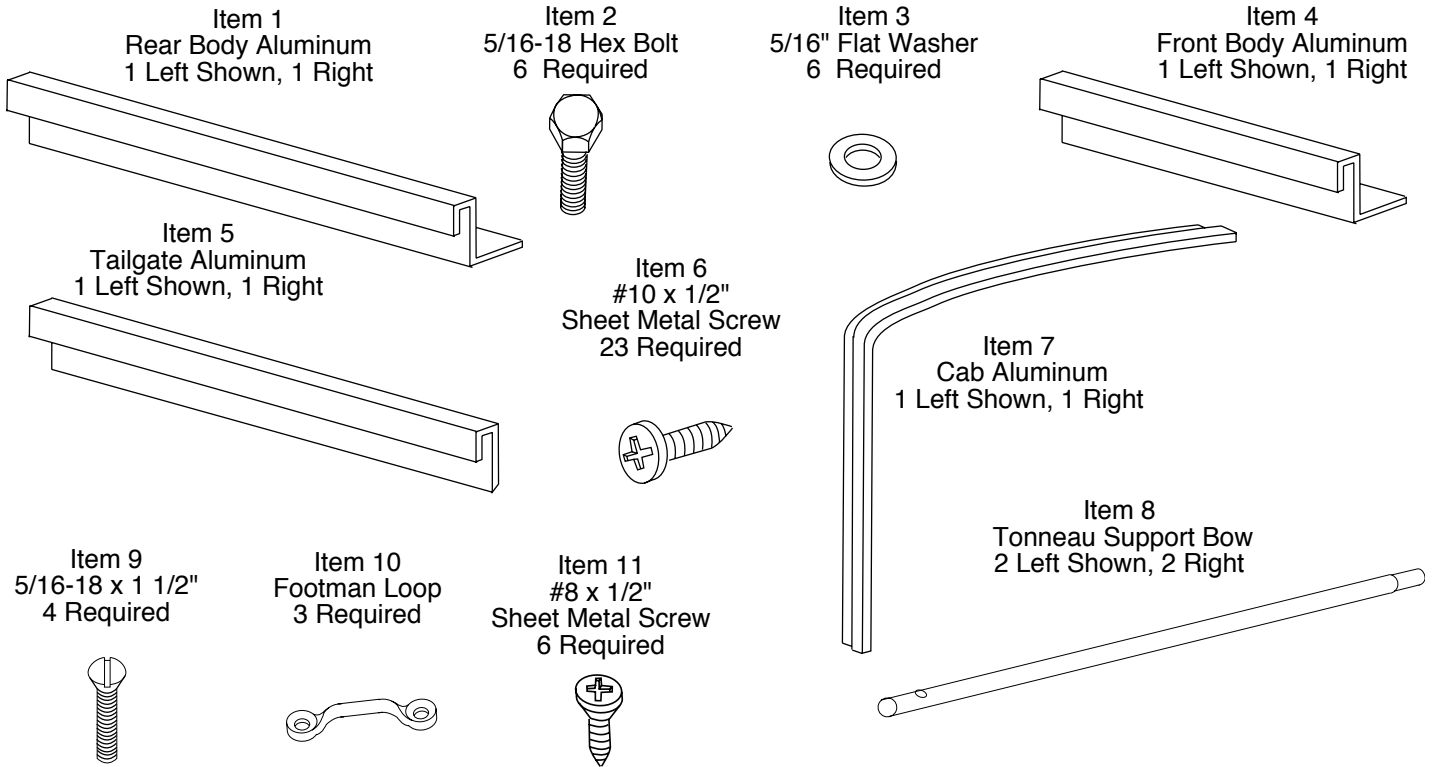

CARE INSTRUCTIONS

Convertible tops and accessories require special care if you want to get the maximum usage and enjoyment from them. The following recommendations, if followed carefully, can extend the life of your top or accessory.

1. Hand wash using a mild non-detergent soap such as Ivory. Use a nonabrasive cloth or sponge. Rinse thoroughly.
2. **DO NOT** wash in direct sunlight and avoid automatic car washes.
3. When your tonneau and cab curtain are clean, we recommend using "303 Protectant" on both the vinyl and window. This product contains a sunscreen that helps protect from the sun's damaging rays. Stay away from products containing alcohol as it will cause the fabric and windows to lose their elasticity, thus reducing the life of your top or accessory. If you are unable to locate "303 Protectant", please call 1-800-223-4303 for a distributor near you.
4. Direct sunlight and heat are the biggest enemies of the window. Park in the shade whenever possible.
5. **NEVER** use ice scrapers or snow brushes on vinyl window.

WARRANTY INFORMATION:

Specialty Top Co. warrants to the original purchaser of any product it manufactures, that the product will be free of defects in material or workmanship for a period of 90 days from date of purchase. Such obligations under this warranty shall be limited to the **repair or replacement**, at Specialty's discretion, of any assembly or parts which upon examination by Specialty Top Co. proves to be defective. All defective items must be returned with proof of purchase to Specialty Top Co., 200 East 64th Avenue, Denver, Colorado 80221, freight prepaid. This warranty does not cover damage resulting from abuse, misuse, alteration, accident or damage in transit. Specialty's obligations under this warranty are limited to the aforementioned repair or replacement of warranty defects for which the return authorization has been received during the warranty period, and **SPECIALTY TOP CO. SHALL NOT BE LIABLE FOR ANY INCIDENTAL OR CONSEQUENTIAL DAMAGES ARISING FROM BREACH OF THIS OR ANY IMPLIED WARRANTY.**

Some states do not allow the exclusion or limitation of incidental or consequential damages, so the above limitation or exclusion may not apply to you. This warranty gives you specific legal rights, and you may also have other rights which may vary from state to state.

If you need assistance or further information, you may contact Specialty Top Co. at 1-866-487-9944 between the hours of 8:00 AM and 5:00 PM, Monday through Friday, Mountain Standard Time.