



SPECIALTY TOP CO.

INSTALLATION INSTRUCTIONS SCRAMBLER DOORS PART #108-00X

Thank you for purchasing Specialty's Doors for your vehicle. They have been designed for great fit and long wear. Please read and follow, precisely, all installation instructions provided when installing your doors. Failure to do so may result in a poor fitting doors and could place occupants in a potentially hazardous situation.

TOOLS REQUIRED:

3/8" WRENCH 7/16" WRENCH
SCISSORS SHARP KNIFE
LARGE STRAIGHT BLADE SCREWDRIVER
#2 PHILLIPS SCREWDRIVER

Step 1. Paddle Handle. Using a pair of scissors or sharp knife, cut an "X" into fabric from corner to corner of door plate. Using the door plate as a template; cut fabric off to edges of square shape in door plate. Cut slits in fabric for screw holes and notches in door plate. Place paddle handle (Item 1) from the outside of the door through square hole in the door plate. Place #10 x 1/2" screws (Item 4) through paddle handle, slits in fabric and holes in door plate. Secure with #10 lock nuts (Item 3). Then screw inside door knob (Item 2) into hole on inside of paddle handle. Repeat for the other side. See figure 1.

Step 2. Door Striker. You will need to install door strikers on the vertical rod brackets. See figure 2. The holes in the strikers go to the outside of the vehicle with the flange on the striker to the front. Insert 1/4"-20 X 5/8" flat head machine screw (item 7) through lower hole in door striker (item 6) and vertical rod bracket. Install #12 flat washer (item 8) and 1/4"-20 lock nut (item 5) on machine screw and tighten. Repeat for other side.

CUT SLITS FOR
SCREWS, NOTCHES AND PADDLE HANDLE

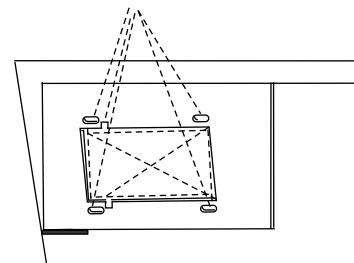

Figure 1

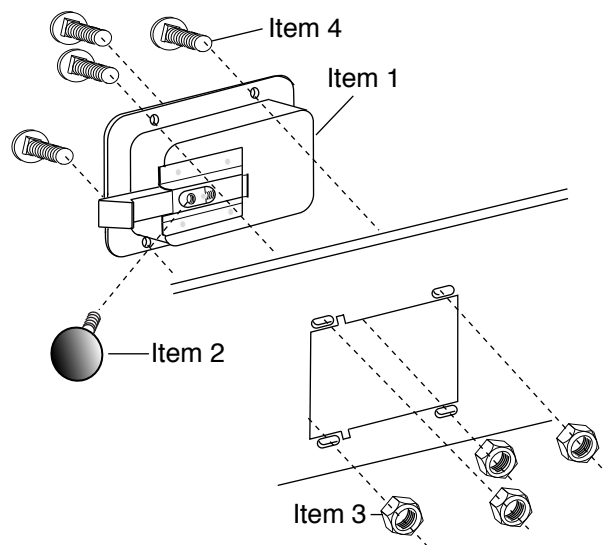
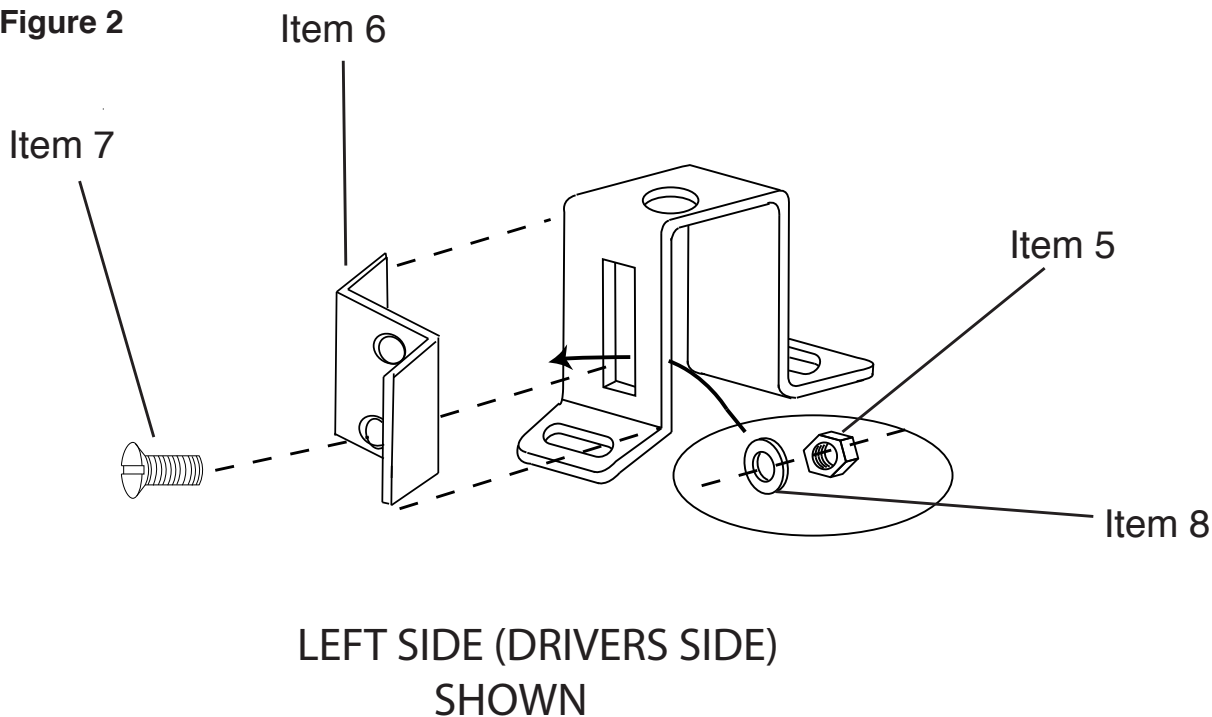

Figure 2



Step 3. Fitting Door In Opening. Each door has two hinge hooks on the lower half of the door, which fit into the original equipment hinges for the hard doors. Insert the hinge hooks into the body hinges. Close the door and check the fit of the paddle handle latch to the striker. If the latch fits too tightly, you can loosen it by pivoting the front of the vertical rod bracket outwards, If the latch does not fit tightly enough, you can tighten it by pivoting the front of the vertical rod bracket inwards. Pivoting the vertical rod bracket is accomplished by loosening the bolt at the front of the bracket and pushing the front of the bracket in the direction desired. Re-tighten the bolt after the bracket is moved. Due to inconsistencies in manufacturing of the vehicle and door frames, some minor bending of the door may be necessary to obtain the proper fit.

WARRANTY INFORMATION:

Specialty Top Co. warrants to the original purchaser of any product it manufactures, that the product will be free of defects in material or workmanship for a period of 90 days from date of purchase. Such obligations under this warranty shall be limited to the repair or replacement, at Specialty's discretion, of any assembly or parts which upon examination by Specialty Top Co. proves to be defective. All defective items must be returned with proof of purchase to Specialty Top Co., 200 East 64th Avenue, Denver, Colorado 80221, freight prepaid. This warranty does not cover damage resulting from abuse, misuse, alteration, accident or damage in transit. Specialty's obligations under this warranty are limited to the aforementioned repair or replacement of warranty defects for which the return authorization has been received during the warranty period, and **SPECIALTY TOP CO. SHALL NOT BE LIABLE FOR ANY INCIDENTAL OR CONSEQUENTIAL DAMAGES ARISING FROM BREACH OF THIS OR ANY IMPLIED WARRANTY.**

Some states do not allow the exclusion or limitation of incidental or consequential damages, so the above limitation or exclusion may not apply to you. This warranty gives you specific legal rights, and you may also have other rights which may vary from state to state.

If you need assistance or further information, you may contact Specialty Top Co. at 1-866-487-9944 between the hours of 8:00 AM and 5:00 PM, Monday through Friday, Mountain Standard Time.

DOOR ASSEMBLY PARTS LIST

Item 1
Paddle Handle
2

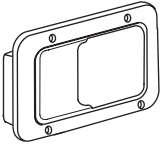

Item 2
Paddle Handle
Inside Knob
2



Item 3
#10-24 Lock Nut
8



Item 4
#10-24 X 1/2"
Phillips Screw
8



Item 5
1/4 - 20 Lock Nut
2



Item 6
Door Striker
2



Item 7
1/4 - 20 X 5/8"
Flat Head Machine Screw
2



Item 8
#12 Flat Washer
2



CARE INSTRUCTIONS

Convertible tops and accessories require special care if you want to get the maximum usage and enjoyment from them. The following recommendations, if followed carefully, can extend the life of your top or accessory.

1. Hand wash using a mild non-detergent soap such as Ivory. Use a nonabrasive cloth or sponge. Rinse thoroughly.
2. **DO NOT** wash in direct sunlight and avoid automatic car washes.
3. When your doors are clean, we recommend using "303 Protectant" on both the vinyl and windows. This product contains a sunscreen that helps protect from the sun's damaging rays. Stay away from products containing alcohol as it will cause the fabric and windows to lose their elasticity, thus reducing the life of your top or accessory. If you are unable to locate "303 Protectant", **please call 1-800-223-4303 for a distributor near you.**
4. Direct sunlight and heat are the biggest enemies of the windows. Park in the shade whenever possible. If you must park in the sunlight, rotate the direction that you park every few days so all windows get even exposure.
5. **DO NOT** open or roll up windows at temperatures below 45 degrees F. This could cause them to crack or break.
6. **NEVER** use ice scrapers or snow brushes on vinyl windows.

